

"See Thru the Night"

ASIR-36X-DN

Infra-Red LED PTZ Night Vision Camera

- 432X zoom (36X optical, 12X digital)
- 350 Feet range illumination in total darkness
- 2,000 Feet viewing in daytime
- Weather-proof, high die-cast aluminum housing with IP-66 rating and wiper over camera lens
- Full 360° rotation with 180° tilt
- Supports Pelco D and other standard protocols
- 128 Presets and 6 auto cruise settings



Camera Dimensions

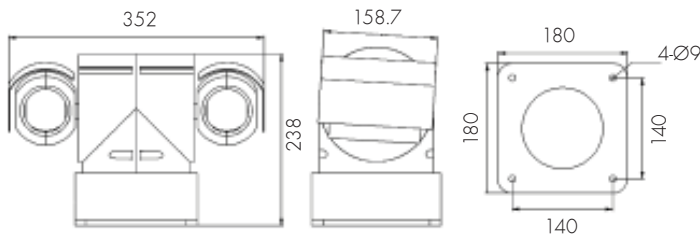

Shock Absorber
Vehicle Mount



Wall Bracket

Camera Specifications

MODEL	ASIR-26X-DN
IMAGE SENSOR	1/4 ExView HAD CCD
ACTIVE PIXELS	752H x 582V
SYNCHRONIZATION	Internal / Extrinsic
VIDEO OUTPUT	1.0Vp-p at 75ohm
WHITE BALANCE	Auto / Manual
SCANNING FREQUENCY	15.6KHz(H) 50Hz
HORIZONTAL RESOLUTION	480TVL
S/N RATIO	>50dB
ELECTRONIC SHUTTER	1/1 ~ 1/10,000s
MIN. ILLUMINATION	0.01Lux
FOCAL LENS	f=3.5~91mm
ZOOM	Total: 432X Optical: 36X Digital: 12X
FOCAL & IRIS	Auto / Manual

Mechanical Specifications

MODEL	ASIR-26X-DN
PRESET PAN SPEED	80°/s
PRESET TILT SPEED	60°/s
MANUAL PAN SPEED	0°~60°/s
MANUAL TILT SPEED	0°~40°/s
PAN RANGE	360° continuously
TILT RANGE	+88° ~ -87°
PRESET POSITIONS & CRUISING TRACKS	128 (Max.), 6 tracks
COMMUNICATIONS	Multi-protocol, RS485
WORK TEMPERATURE	-31°F ~ +131°F (-35°C ~ +55°C)
RELATIVE HUMIDITY	90%
IP GRADE	IP66
POWER SUPPLY	AC24V
IMPACT RESISTANCE	≥4G
WEIGHT	15.5lbs (7Kg)